

BASE VALVE DISC STACK

REVISIONS				
ZONE	REV	DESCRIPTION	DATE	APPROVED

PART DESCRIPTION				
CANISTER BASE ASSEMBLY - EXPLODED				
MATERIAL		MATERIAL		
DRAWN BY		KWK	APPROVAL	
			MLZ	
SIZE	FSCM NO.	DWG NO.		REV
B		310 404XX		C
SCALE		SHEET		1 OF 4
1" = 3"				

THIS DRAWING, INFORMATION, AND TECHNICAL DATA CONTAINED WITHIN ARE THE EXCLUSIVE PROPERTY OF INTEGRA RACING SHOCKS AND SHALL BE RETURNED UPON REQUEST. THIS DRAWING IS NOT TO BE REPRODUCED IN WHOLE OR IN PART, NOR SHALL ANY INFORMATION OR TECHNICAL DATA BE SUPPLIED, IN ANY FORM, TO ANYONE ELSE WITHOUT THE EXPRESS WRITTEN CONSENT OF INTEGRA RACING SHOCKS

BREAK EDGES .010 +/- 0.005" X 45°, FILLET RADII 0.010" +/- 0.005" TOLERANCES (UOS): .XX +/- .01", .XXX +/- .003", ANG +/- 0.5° ALL SURFACE FINISHES TO BE Ra 64 OR BETTER UNLESS OTHERWISE SPECIFIED.



Item Number	Quantity	Part Number	Part Name
1	1	310 30337-2	Tank Valve Cap
2	2	310 30211	Rod Guide O-ring,Primary
3	1	310 30375	Canister Wiper
4	1	310 30376	Screw, Adjuster Knob
5	1	310 30366-50	Canister Adjuster Cap Assembly
6	2	310 30230	Stud - Swivel Banjo
7	1	310 30365	Thumb Wheel Canister
8	1	310 30362-50	Shaft - Bleed Adjuster
9	1	310 30212	O-ring, End Cap
10	2	310 30373	Pin For Bleed Valve
11	1	310 40TKVL001312	Tank Valve
12	1	310 30360	Body - Bleed Valve
13	1	310 30352	Retaining Ring - Canister Tube
14	1	310 30214	Canister Wear Band (Cut to Length)
15	3	310 30372	.188" Detent Ball
16	1	310 30328	Retaining Ring, Spherical Bearing
17	2	310 30332	O-ring Swivel Banjo Stud
18	3	310 OR-011VT75	O-ring Banjo Fitting
19	1	310 3041X	Canister Pressure Tube (Specify Length)
20	1	310 30368	Canister Tube
21	1	310 30370	Base Valve Check Disc
22	4	310 OR-010VT75	O-ring Bleed Plate
23	1	310 30346	Base Valve Body
24	1	310 30351	Check Spring
25	1	310 30367	Canister Floating Piston
26	1	310 30327	Spherical Bearing
27	2	310 30412	Retaining Ring - Banjo Fitting
28	1	310 30369	Bushing - Canister
29	1	310 OR-319VT75	O-ring Floating Piston, Canister
30	1	310 30408	End Cap, Pressure Tube

Item Number	Quantity	Part Number	Part Name
31	1	310 30361	Bleed Valve Plate
32	1	SEE BLOW UP	Base Valve Disc Stack for Standard Build
33	1	310 30363	Base Valve Bolt - Canister
34	1	310 30364	Schrader Valve End Cap - Canister
35	1	310 30382-20S	Canister Hose Assembly
36	1	310 OR-130VT75	O-ring Tube Canister
37	1	310 MVD594020	Backup Disc/Torque Washer
38	1	310 MVD7010	.700" DIA Main Valve Disc x .010" Thick
39	1	310 MVD85010	.850 DIA Main Valve Disc x .010" Thick
40	3	310 MVD1012	1.00" DIA Main Valve Disx x .012" Thick

REVISIONS				
ZONE	REV	DESCRIPTION	DATE	APPROVED

PART DESCRIPTION				
<b>CANISTER BASE ASSEMBLY - PARTS LIST</b>				
MATERIAL				
DRAWN BY			APPROVAL	
KWK			MLZ	
SIZE	FSCM NO.	DWG NO.		REV
<b>B</b>				<b>C</b>
SCALE			SHEET 2 OF 4	

THIS DRAWING, INFORMATION, AND TECHNICAL DATA CONTAINED WITHIN ARE THE EXCLUSIVE PROPERTY OF INTEGRA RACING SHOCKS AND SHALL BE RETURNED UPON REQUEST. THIS DRAWING IS NOT TO BE REPRODUCED IN WHOLE OR IN PART, NOR SHALL ANY INFORMATION OR TECHNICAL DATA BE SUPPLIED, IN ANY FORM, TO ANYONE ELSE WITHOUT THE EXPRESS WRITTEN CONSENT OF INTEGRA RACING SHOCKS

BREAK EDGES .010 +/- 0.005" X 45°, FILLET RADII 0.010" +/- 0.005" TOLERANCES (UOS): .XX +/- .01", .XXX +/- .003", ANG +/- 0.5° ALL SURFACE FINISHES TO BE Ra 64 OR BETTER UNLESS OTHERWISE SPECIFIED.

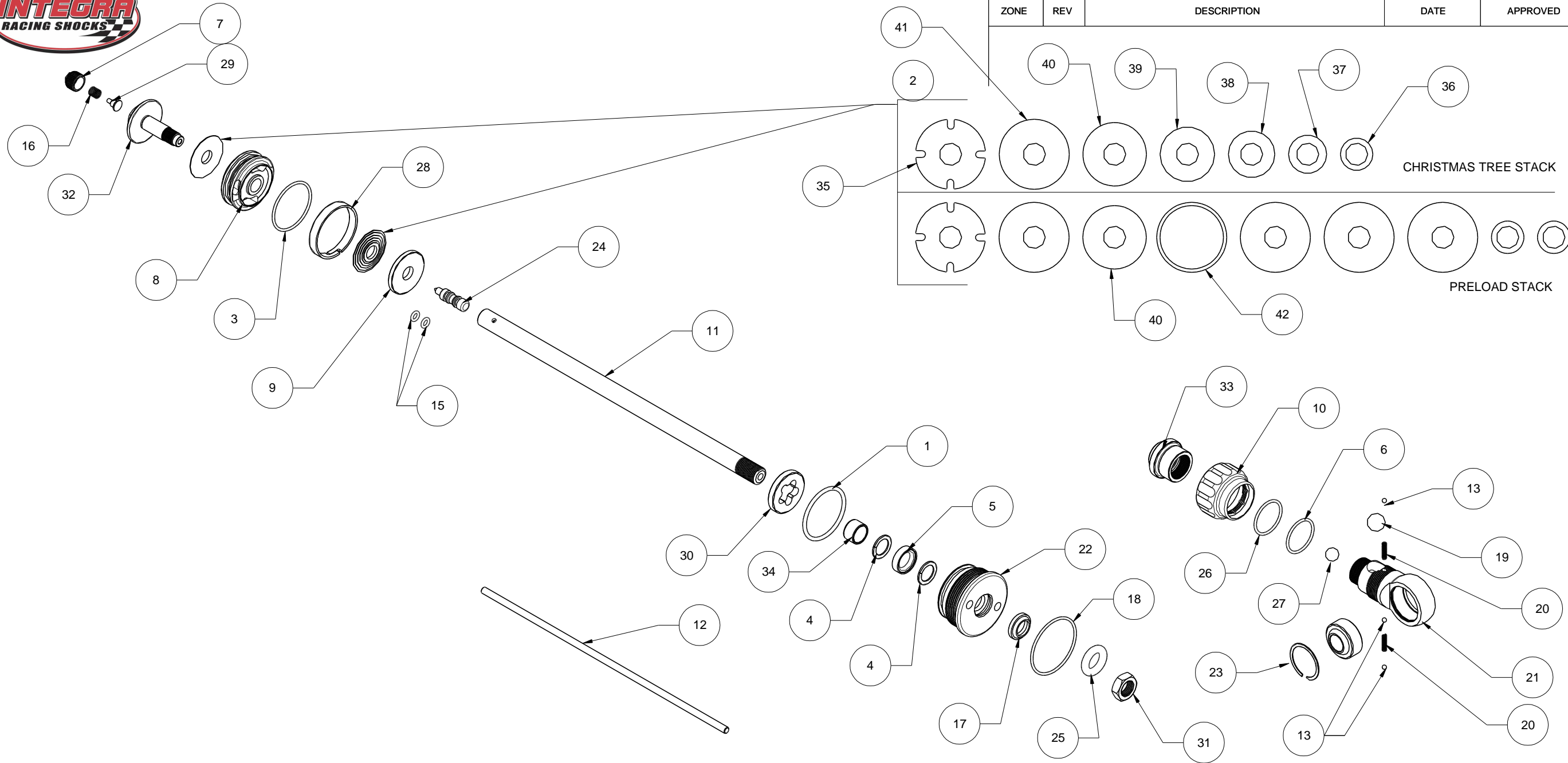

REVISIONS				
ZONE	REV	DESCRIPTION	DATE	APPROVED

		40	39	38	37	36	
		40		42			

CHRISTMAS TREE STACK

PRELOAD STACK

PART DESCRIPTION			
CANISTER HEAD ASSEMBLY - EXPLODED			
MATERIAL			
MATERIAL			
DRAWN BY		APPROVAL	
KWK		MLZ	
SIZE	FSCM NO.	DWG NO.	REV
B		310 404XX	C
SCALE		SHEET	
1" = 3"		3 OF 4	

THIS DRAWING, INFORMATION, AND TECHNICAL DATA CONTAINED WITHIN ARE THE EXCLUSIVE PROPERTY OF INTEGRA RACING SHOCKS AND SHALL BE RETURNED UPON REQUEST. THIS DRAWING IS NOT TO BE REPRODUCED IN WHOLE OR IN PART, NOR SHALL ANY INFORMATION OR TECHNICAL DATA BE SUPPLIED, IN ANY FORM, TO ANYONE ELSE WITHOUT THE EXPRESS WRITTEN CONSENT OF INTEGRA RACING SHOCKS

BREAK EDGES .010 +/- 0.005" X 45°, FILLET RADII 0.010" +/- 0.005"  
 TOLERANCES (UOS): .XX +/- .01", .XXX +/- .003", ANG +/- 0.5°  
 ALL SURFACE FINISHES TO BE Ra 64 OR BETTER UNLESS OTHERWISE SPECIFIED.



REVISIONS				
ZONE	REV	DESCRIPTION	DATE	APPROVED
	A	RELEASED	22 MAR 2010	
	B	UPDATED PARTS AND PART NUMBERS	23 APR 2011	
	C	CREATED 3D MODEL AND ADDED/UPDATED PART NUMBERS	19 JULY 2011	

Item Number	Quantity	Part Number	Part Name
1	1	310 30211	Rod Guide O-ring,Primary
2	2	SEE BLOW UP	Disc Stack, Standard
3	1	310 30215	Piston Band Energizing O-Ring
4	2	310 30281	Seal - Low Friction_B
5	1	310 30281	Seal - Low Friction_A
6	1	310 30426	O-Ring Adjustable Rod End
7	1	310 30392	Poppet Seat
8	1	310 30322/30323/30325	Piston, Digressive/Linear/Linear-Digressive
9	1	310 30396	Travel Limiter
10	1	310 30414	Adjuster Knob
11	1	310 3038X	Adjustable Piston Rod (Specify Length)
12	1	310 3035X	Adjuster Rod (Specify Length)
13	3	310 30380	.125" Ball
14	1	310 30327	Spherical Bearing
15	2	310 OR-008BV75	O-ring Needle
16	1	310 30324	Poppet Spring
17	1	310 30280	Wiper - Low Friction
18	1	310 30210	Rod Guide O-ring, Secondary
19	1	310 30427	.500" Ball Bearing
20	2	310 701393S	Detent Spring
21	1	310 30409	Adjustable Rod End Assembly
22	1	310 30300	Aluminum Rod Guide, Low Fric
23	1	310 30328	Retaining Ring, Spherical Bearing
24	1	310 30390/30390-1/-2	Needle, 64°/24°/48°
25	1	310 30218	Travel Marker
26	1	310 30429	O-ring, Precision Adjustable Rod End
27	1	310 30428	.375" Ball Bearing
28	1	310 30214	Piston Band
29	1	310 30393	Poppet
30	1	310 30411	Delrin Washer

Item Number	Quantity	Part Number	Part Name
31	1	310 30377	1/2" x 11/16" Jam Nut
32	1	310 30391	Piston Post
33	1	310 30415	Rod End Adapter
34	1	310 30300-1	Rod Guide DU Bearing
35	1	310 BD0XX-X	Bleed Disc (Specify Thickness and Bleed)
36	1	310 MVD594020	Backup Disc/Torque Washer
37	1	310 MVD70XX	.700" Main Valve Disc (Specify Thickness)
38	1	310 MVD850XX	.850" Main Valve Disc (Specify Thickness)
39	1	310 MVD10XX	1.00" Main Valve Disc (Specify Thickness)
40	1	310 MVD1160XX	1.16" Main Valve Disc (Specify Thickness)
41	1	310 MVD1280XX	1.28" Main Valve Disc (Specify Thickness)
42	1	310 PR1280XX	Preload Ring Disc (Specify Thickness)

PART DESCRIPTION			
<b>CANISTER HEAD ASSEMBLY - PARTS LIST</b>			
MATERIAL			
DRAWN BY		APPROVAL	
KWK		MLZ	
SIZE	FSCM NO.	DWG NO.	REV
<b>B</b>			<b>C</b>
SCALE		SHEET 4 OF 4	

THIS DRAWING, INFORMATION, AND TECHNICAL DATA CONTAINED WITHIN ARE THE EXCLUSIVE PROPERTY OF INTEGRA RACING SHOCKS AND SHALL BE RETURNED UPON REQUEST. THIS DRAWING IS NOT TO BE REPRODUCED IN WHOLE OR IN PART, NOR SHALL ANY INFORMATION OR TECHNICAL DATA BE SUPPLIED, IN ANY FORM, TO ANYONE ELSE WITHOUT THE EXPRESS WRITTEN CONSENT OF INTEGRA RACING SHOCKS

BREAK EDGES .010 +/- 0.005" X 45°, FILLET RADII 0.010" +/- 0.005" TOLERANCES (UOS): .XX +/- .01", .XXX +/- .003", ANG +/- 0.5° ALL SURFACE FINISHES TO BE Ra 64 OR BETTER UNLESS OTHERWISE SPECIFIED.